

PRODUCT DATA SHEET

Control Systems

Transmitters

Sensors

Accessories



TOCSIN 625

Fast, Effective Gas Detection System Controller

TOC-625 is a multi-channel detector controller in an easily installed and implemented small format package. *The Controller features our industry first: 1 Click Automatic Alarm Setup function.* The system will automatically set all alarm levels up for the connected sensors to EH40 and DSEAR Regulations with 1 click of a button. The system can be used with any of the Tocsin Addressable range detectors or I/O modules providing maximum flexibility. The controller can be wall mounted or panel mounted and has a pump and duct mount options. The controller has two SPCO relays as standard with three 4-20mA outputs.



1-Click Setup Features

- 1 Click Automatic Alarm Setup Function
- 1-8 Devices on one cable
- Wall or Panel Mounting
- Relay Outputs as Standard
- 4-20mA Outputs as Standard
- Control up to 8 Devices as Gas Detectors or I/O Modules
- LCD Display With Multi Colour
- Backlight, Flashes Red on Alarm,
- Flashes Yellow on Fault etc
- Battery Backup Option

Standard Specifications

Power	110/230V AC 50/60Hz 25W Standard 24V DC Option
Construction	ABS
Display	2 Lines x 8 Digit LCD Display Multi-Colour Backlight (Red-Alarm, Yellow-Fault, Blue-Normal)
Outputs	2 off SPCO Relays 4A Non-Inductive User Configurable 3 off 4-20mA Linear Outputs User Configurable
Other I/O	Sounder 80dB @ 100mm (Mutable)
Inputs	8 off Addressable Series Detectors or I/O Modules
Temperature	-5 to 55 Deg C
Humidity	0-95% RH Non-Condensing
Sealing	IP54
Mounting	Wall Mount, Panel Mount Kit Option, Duct Mount Kit Option
Weight	840g



Triton House
Crosby Street
Stockport
SK2 6SH
England

Tel: +44 (0)161 483 1415
Fax: +44 (0) 161 484 2345
Email: sales@internationalgasdetectors.co.uk
Website: www.internationalgasdetectors.co.uk

Document Ref: ROS625 V7.1



FS646773

EMS696504

PRODUCT DATA SHEET

Control Systems

Transmitters

Sensors

Accessories

EC Declaration of Conformity

Issuers name and address:

Oliver IGD Limited of
Triton House,
Crosby Street,
Stockport, SK2 6SH
England



Declares that the product listed as:

TOC-625

Single or Multi-Channel Detector Control Panel

Are in conformity with the provisions of the following European Directive(s) when installed, operated, serviced and maintained in accordance with the installation and operating instructions contained in the product documentation.

2004/108/EC
2014/34/EU

EMC Directive
Low Voltage Equipment Directive (note not applicable to 24V DC Powered Versions)

And that the standards and/or technical specifications referenced below have been applied or considered.

EN 60079-29-1:2016 Explosive Atmospheres. Gas Detectors. Performance Requirements of Detectors for Flammable Gases. **conforms to**

EN 50271:2018 Electrical apparatus for the detection and measurement of combustible gases, toxic gases or Oxygen: requirements and tests for apparatus using software and or digital technologies. Excluding requirements for SIL

EN 61000-6-2: 2005 EMC Generic standards. Immunity for industrial environments
EN 61000-6-4: 2007 EMC Generic standards. Emission standard for industrial environments
EN 61000-3-2/A2:2009 EMC Limits. Limits for harmonic current emissions (equipment input current ≤ 16 A per phase)
EN 61000-3-3: 2008 EMC Limits. Limitation of voltage changes, voltage fluctuations and flicker in public low-voltage supply systems, for equipment with rated current ≤ 16 A per phase

Technical File Reference

T625-TF9

Oliver IGD Limited Operate an
Independently assessed ATEX/IECEX
QAN.

Quality Assurance Certificate Number
16PQAN0014

Quality Assurance Notification Number:
2585



Units 16-18 Abenbury Way,
Wrexham Industrial Estate,
Wrexham, LL13 9UZ
United Kingdom



Oliver IGD Limited operate an independently
assessed ISO9001:2015 Quality Management and
ISO14001:2015 Environmental Management System

Certificate Numbers
FS0646773 & EMS696504

BSI Assurance UK LTD,
London, W4 4AL
United Kingdom

EMC Tested by:

TUV - SUD
Octagon House
Concorde Way
PO 15 5RL Fareham



Certificate Number
E8N 15 02 91327 001

TUV Certificates and reports can be checked on-line at
https://www.tuev-sued.de/industry_and_consumer_products/certificates
Select Oliver IGD when prompted on the website to view certificates

Issued by: Oliver IGD Limited, Stockport, SK2 6SH, United Kingdom

Signature:

Declaration of Conformity in accordance with EN ISO/IEC 17050-1:2010

Name:

Andrew J Collier M.I.O.D

Position:

Managing Director

Date: 06/06/2019

Declaration Ref: TOC-625-DEC-3



Triton House
Crosby Street
Stockport
SK2 6SH
England

Tel: +44 (0)161 483 1415
Fax: +44 (0) 161 484 2345
Email: sales@internationalgasdetectors.co.uk
Website: www.internationalgasdetectors.co.uk



FS646773

EMS696504

Document Ref: ROS625 V7.1

PRODUCT DATA SHEET

Control Systems

Transmitters

Sensors

Accessories

REAR VIEW

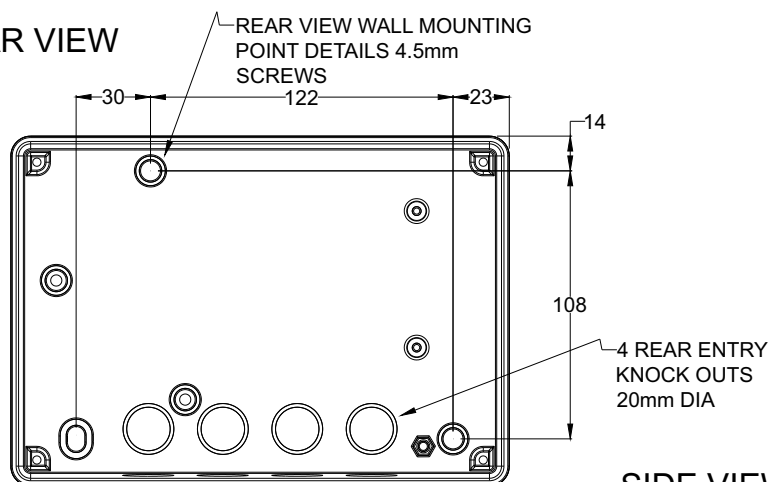

FRONT VIEW

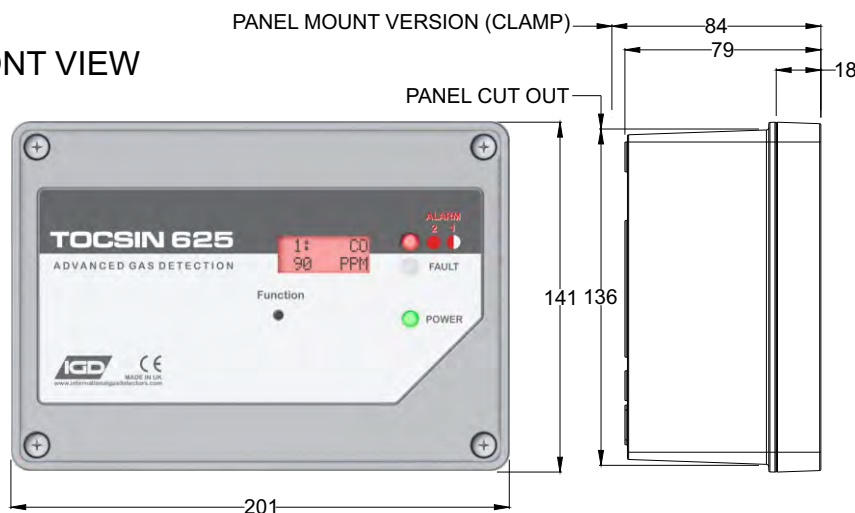

BOTTOM VIEW

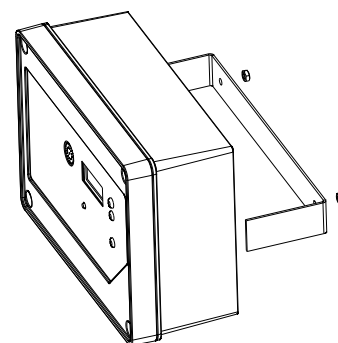
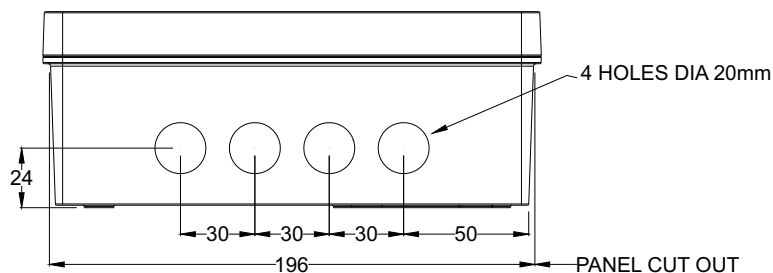

Optional Panel Mounting Kit
PN 5686401

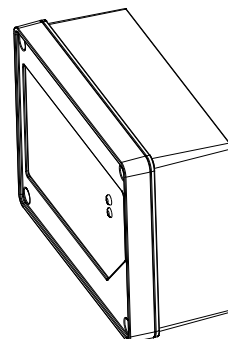

Optional Battery Backup Kit
PN 5686601

Note this module uses the same style enclosure as the TOC-625 and houses batteries and charge control. It is usually mounted below the TOC-625 and is supplied with all required connectors.



Triton House
Crosby Street
Stockport
SK2 6SH
England

Tel: +44 (0)161 483 1415
Fax: +44 (0) 161 484 2345
Email: sales@internationalgasdetectors.co.uk
Website: www.internationalgasdetectors.co.uk

Document Ref: ROS625 V7.1



FS646773

EMS696504

PRODUCT DATA SHEET

Control Systems

Transmitters

Sensors

Accessories

1 Click Automatic Alarm Setup Function - Easy to Install With No Gas Detection Knowledge Needed.

Flammable Gas Detection

Toxic Gas Detection

Oxygen Depletion

Innovative Gas Detection Since 1917



Combine Controllers With Detectors and I/O Nodes as Required, with our industry first 1 Click Automatic Alarm Setup Function. Once you have connected all your sensors. Press the setup wizard and the controller will find all connected devices and set the alarm levels up, in accordance to EH 40 and DESEAR regulations. Once it has finished bump test the connected sensors. 1-8 Sensors.

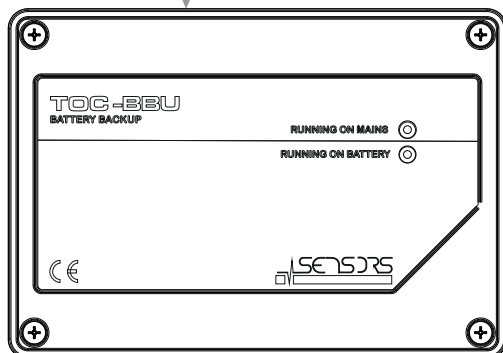

Use with TOC-30 Series Detectors and I/O modules. ABS housed detectors sealed up to IP65 rating.



This detector series is standard 2 gang mount for surface, flush mounting or mounting to dado rail.



Interface to TOC-30 Series annunciators for additional I/O functions. The smart alternative to beacons, sounders and slam switches.

TOC-625 Controller 110/230V AC	5685401
TOC-625 Controller 24V DC	5686501

TOC-625 Controller Panel Mount Kit	5686401
TOC-625 Battery Backup Module	5686601



Triton House
Crosby Street
Stockport
SK2 6SH
England

Tel: +44 (0)161 483 1415
Fax: +44 (0) 161 484 2345
Email: sales@internationalgasdetectors.co.uk
Website: www.internationalgasdetectors.co.uk

Document Ref: ROS625 V7.1



FS646773

EMS696504

PRODUCT DATA SHEET

Control Systems

Transmitters

Sensors

Accessories

Auto Setup Table

Gas \ Outputs	Range	Type	Alarm 1 / Relay 1	Alarm 2 / Relay 2
Flammables	0-100% LEL	Rising - Latching	10% LEL	20% LEL
Carbon Monoxide	0-100ppm	Rising - Latching	20ppm	55ppm
Carbon Dioxide	0-5000ppm	Rising - Latching	3500ppm	4500ppm
Carbon Dioxide	0-5%	Rising - Latching	0.5%	1.5%
Chlorine	0-5ppm	Rising - Latching	0.2ppm	0.5ppm
Oxygen	0-25%	Falling - Latching	19.5%	18.5%
Hydrogen Sulphide	0-50ppm	Rising - Latching	5ppm	10ppm

Relay 1 and Relay 2 on the TOC-625 Controller are set to be normally energised, de-energising on alarm or power failure.

The TOC-625 Controller can FIND up to 8 devices. These can be any mix of gas detectors and output nodes

The TOC-625 Controller can FIND up to 2 relay output nodes. Relay nodes supplied with TOC-625 Controller need to be addressed as follows and will operate according to the following table.

Relays Active on First Alarm	Output Node 1		Output Node 2	
	Relay 1	Relay 2 Mutable	Relay 1	Relay 2 Mutable
Node Relay Address	4201	4202	4203	4204

Note that mutable relays re-energise on second alarm.



**One Cable
Automatic Setup
Up to 6 Detectors
Up to 2 Relay Modules**

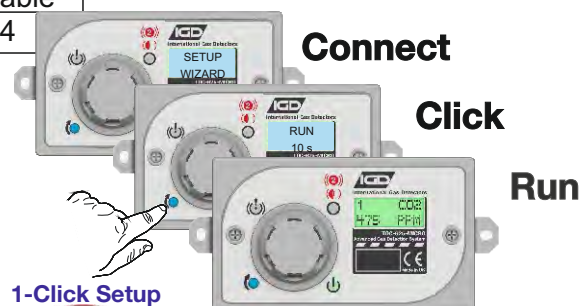

1-Click Setup



Triton House
Crosby Street
Stockport
SK2 6SH
England

Tel: +44 (0)161 483 1415
Fax: +44 (0) 161 484 2345
Email: sales@internationalgasdetectors.co.uk
Website: www.internationalgasdetectors.co.uk



FS646773

EMS696504

Document Ref: ROS625 V7.1

PRODUCT DATA SHEET

Control Systems

Transmitters

Sensors

Accessories

Analogue Output Interfaces

+24V DC
- 24V DC
mA Sig 1
mA Sig 2
mA Sig 3

Note as standard mA outputs are set. These can be re-configured as 0-10V signals

Mains Power Connector
110/230V AC 50/60Hz

L	n	c	N	n	c	E
---	---	---	---	---	---	---

Front View Cover Open

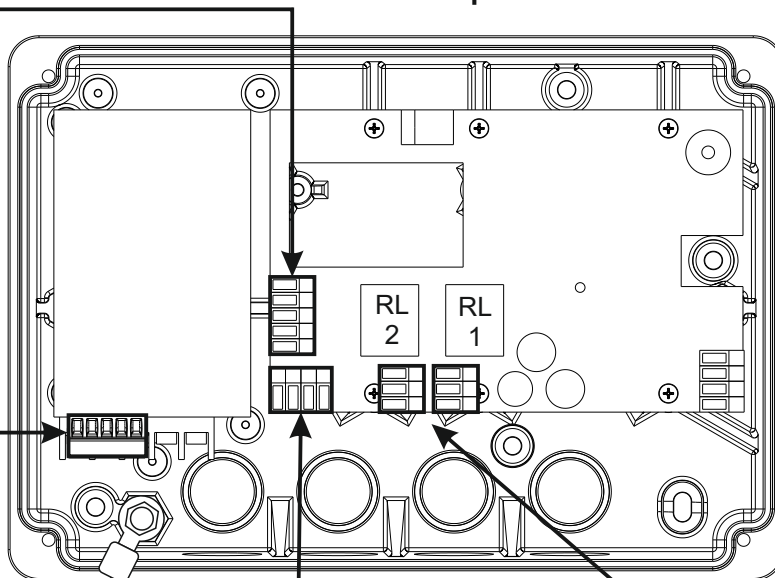

Connect to detectors and nodes using 4 core 1.5mmSQ CY style cable or FP200 style cable as appropriate. Cable screens should be terminated as indicated

Connect up to 8 addressable devices. These can be Gas Detectors or by using the available I/O Nodes any 4-20mA Device such as pressure or temperature transmitters, read these back to the control panel as any other detector and set alarms as required.

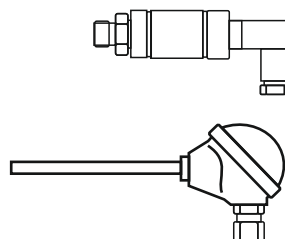

Detector I/O Interface				
0V DC	A	B	24V DC	

Normally Closed
Common
Normally Open

Connections common to each of the two relay outputs

SCRN	0V DC	A	B	24V DC
Detector				
SCRN	0V DC	A	B	24V DC

Gas detectors count as one device, there can be any mix of gas detector types on the highway. For example Flammable Gas Detectors, Carbon Monoxide, Oxygen etc.

SCRN	0V DC	A	B	24V DC
24V DC Input 1	I/O Node			Relay 1 Relay 1
Input 2 0V DC				Relay 2 Relay 2
SCRN	0V DC	A	B	24V DC

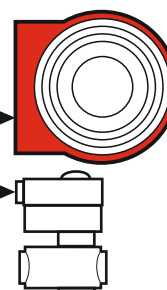

Each I/O Node counts as one device and can be used to interface to analogue devices and provide additional relay outputs where they are needed to control items such as beacon-sounders, solenoids or interfaces to fire panels. Depending on loading external power may be required.



Triton House
Crosby Street
Stockport
SK2 6SH
England

Tel: +44 (0)161 483 1415
Fax: +44 (0) 161 484 2345
Email: sales@internationalgasdetectors.co.uk
Website: www.internationalgasdetectors.co.uk

Document Ref: ROS625 V7.1



FS646773

EMS696504